

Pressure Switch MDR 3

3-phase; Switching capacity 7.5 (11) kW
available with overload relay
max.cut-out pressure 35 bar

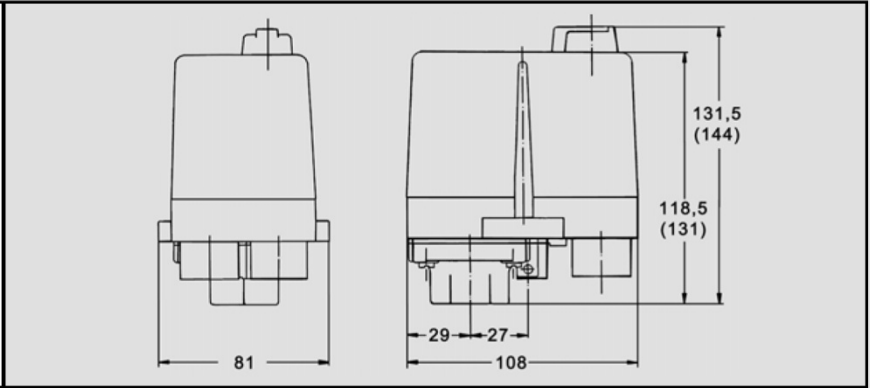

Technical Data MDR 3

Technical Data MDR 3 acc. to EN 60947 UL / CSA	
Rated insulation voltage U_i	690 V
Motor switching capacity (UL 508, CSA 22.2) $U_e=120$ V (1~)	2 HP
Motor switching capacity (AC 3) $U_e=240$ V (1~)	5.5 kW
Motor switching capacity (UL 508, CSA 22.2) $U_e=240$ V (1~)	5 HP
Motor switching capacity (AC 3) $U_e=240$ V (3~)	5.5 kW
Motor switching capacity (UL 508, CSA 22.2) $U_e=240$ V (3~)	7.5 HP
Motor switching capacity (AC 3) $U_e=400$ V (3~)	7.5/11* kW
Motor switching capacity (UL 508, CSA 22.2) $U_e=480$ V (3~)	15 HP
Motor switching capacity (AC 3) $U_e=500$ V (3~)	7.5/11* kW
Motor switching capacity (UL 508, CSA 22.2) $U_e=600$ V (3~)	20 HP
Motor switching capacity (AC 3) $U_e=690$ V (3~)	7.5/11* kW

* With arc-chamber Sk-... H on demand

Technical Data MDR 3 acc. to EN 60947 UL / CSA	
Electrical life (AC 3) Cycles	$> 1 \times 10^5$
Mechanical life Cycles	$> 1 \times 10^6$
Max. electrical cycles Cycles/h	120
Max. mechanical cycles Cycles/h	600
Rated operational current I_o at 240 V AC	24 A
Bursting strength P_z	$\leq 16 > 40$ bar $\geq 25 > 60$ bar
Permissible medium temperature Air	-5...+ 80 °C
Permissible medium temperature Water	+ 80 °C
Degree of Protection acc. to EN 60529	IP 54
Conductor cross-section 1 ... Fine stranded 1 x / 2 x	4 / 2.5 mm ²
Conductor cross-section 1 ... Rigid cable 1 x / 2 x	6 / 4 mm ²

Diaphragm media resistance MDR 3	
Air, Water	resistant

Diaphragm media resistance MDR 3 RM	
Acetylene, Ammonia 25%, Butane, Natural gas, Vinegar 25 %, Ethylene glycol, Glycerol, Urine, Carbon dioxide, Carbonic acid, Air, Vegetable oil, Propane, Silicon oil, Nitrogen, Water, Hydrogen, Sea water	resistant

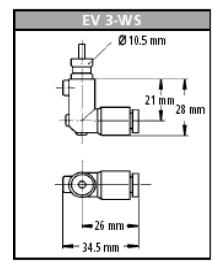
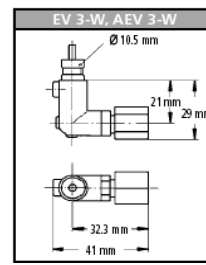
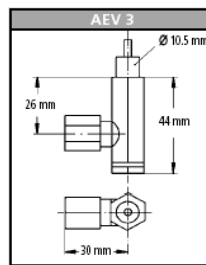
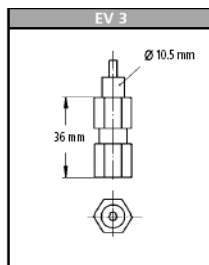
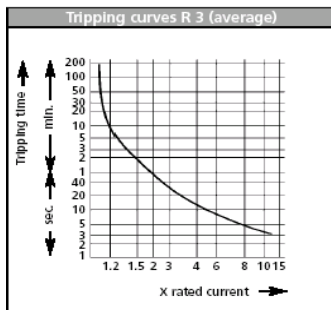

Circuit Diagrams

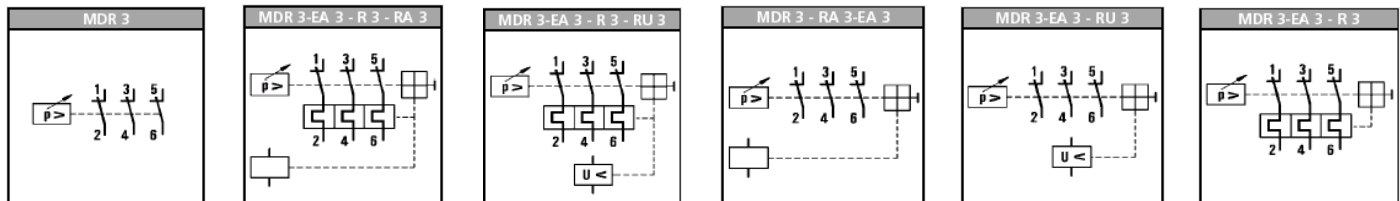

The data provided above is for information purposes only and no warranty of accuracy or reliability is given. Ross Brown Sales Pty Limited reserves the right to change or modify this data without prior notice.



Pressure Switch MDR 3



Pressure Switches

Condor Code	ON/OFF switch	Pressure Range In kPa	Connection	Thermal Overload (Amps)	RM Diaphragm	Weight (gms)	Part Number
600 kPa							
MDR3/600 G1/4 2PG11Z	-	130-600	¼" BSP F	-	-	680	3031010
1100 kPa							
MDR3/1100 G1/4 EA3 2PG13.5Z	EA	400-1100	¼" BSP F	-	-	680	3031021
MDR3/1100 F4-1/4 EA3 2PG13.5Z	EA	400-1100	F4 X ¼" BSP F	-	-	710	3031022
Switches with thermal overload protection							
MDR3/1100 F4-1/4 EA3 R3/4 EV3WS 2PG13.5Z	EA	400-1100	F4 x ¼" BSP F	2.5-4.0	-	750	3031129
MDR3/1100 G1/4 EA3 R3/6.3 EV3Wi 2PG13.5Z	EA	400-1100	¼" BSP F	4.0-6.3	-	740	3031105
MDR3/1100 G1/4 EA3 R3/6.3 EV3i 2PG13.5Z	EA	400-1100	¼" BSP F	4.0-6.3	-	740	3031120
MDR3/1100 F4-1/4 EA3 R3/6.3 EV3WS 2PG13.5Z	EA	400-1100	F4 x ¼" BSP F	4.0-6.3	-	750	3031130
MDR3/1100 G1/4 EA3 R3/10 EV3i 2PG13.5Z	EA	400-1100	¼" BSP F	6.3-10.0	-	740	3031121
MDR3/1100 G1/4 EA3 R3/10 EV3WS 2PG13.5Z	EA	400-1100	¼" BSP F	6.3-10.0	-	740	3031152
MDR3/1100 F4-1/4 EA3 R3/10 EV3WS 2PG13.5Z	EA	400-1100	F4 x ¼" BSP F	6.3-10.0	-	750	3031131
MDR3/1100RM G1/4 EA3 R3/10 EV3Wi 2PG13.5Z	EA	400-1000	¼" BSP F	6.3-10.0	YES	740	3031106
MDR3/1100 G1/4 EA3 R3/16 EV3i 2PG13.5Z	EA	400-1100	¼" BSP F	10-16	-	740	3031122
MDR3/1100 F4-1/4 EA3 R3/16 EV3WS 2PG13.5Z	EA	400-1100	F4 X ¼" BSP F	10-16	-	770	3031132
MDR3/1100RM G1/4 EA3 R3/16 EV3Wi 2PG13.5Z	EA	400-1000	¼" BSP F	10-16	YES	740	3031107
MDR3/1100RM G1/4 EA3 R3/16H EV3Wi 2PG13.5Z	EA	400-1000	¼" BSP F	10-16	YES	740	3031107C
MDR3/1100 G1/4 EA3 R3/20 EV3i 2PG13.5Z	EA	400-1100	¼" BSP F	16-20	-	740	3031123
MDR3/1100 F4-1/4 EA3 R3/20 EV3WS 2PG13.5Z	EA	400-1100	F4 x ¼" BSP F	16-20	-	750	3031133
MDR3/1100RM G1/4 EA3 R3/20 EV3Wi 2PG13.5Z	EA	400-1000	¼" BSP F	16-20	YES	740	3031108
MDR3/1100 G1/4 EA3 R3/24 EV3i 2PG13.5Z	EA	400-1100	¼" BSP F	20-24	-	740	3031124
MDR3/1100RM G1/4 EA3 R3/24 EV3Wi 2PG13.5Z	EA	400-1000	¼" BSP F	20-24	YES	740	3031109
MDR3/1100 G1/4 EA3 R3/30 EV3i 2PG13.5Z	EA	400-1100	¼" BSP F	22-30	-	740	3031125
Switches with thermal overload and shunt release							
MDR3/1100 F4-1/4 EA3 R3/10 RA/230 EV3Wi 2PG13.5Z	EA	400-1100	F4 X ¼" BSP F	6.3-10.0	-	870	3031116
MDR3/1100 F4-1/4 EA3 R3/16 RA/230 EV3Wi 2PG13.5Z	EA	400-1100	F4 X ¼" BSP F	10-16	-	870	3031117
MDR3/1100 F4-1/4 EA3 R3/20 RA/230 EV3Wi 2PG13.5Z	EA	400-1100	F4 X ¼" BSP F	16-20	-	870	3031118
1600 kPa							
MDR3/1600 G1/4 EA3 2PG13.5Z	EA	600-1600	¼" BSP F	-	-	680	3031031
MDR3/1600 F4-1/4 EA3 2PG13.5Z	EA	600-1600	F4 X ¼" BSP F	-	-	710	3031032
MDR3/1600 F4-1/4 EA3 EV3i 2PG13.5Z	EA	600-1600	F4 X ¼" BSP F	-	-	710	3031033
Switches with thermal overload protection							
MDR3/1600 G1/4 EA3 R3/10 EV3WS 2PG13.5Z	EA	600-1600	¼" BSP F	6.3-10.0	-	740	3031036
MDR3/1600 G1/4 EA3 R3/16 EV3WS 2PG13.5Z	EA	600-1600	¼" BSP F	10-16	-	740	3031037
2500 kPa							
MDR3/2500 G1/4 EA3 2PG13.5Z	EA	750-2500	¼" BSP F	-	-	710	3031041
3500 kPa							
MDR3/3500 G1/2 EA3 2PG13.5Z	EA	1200-3500	½" BSP F	-	-	700	3031043

Pressure Switch Accessories

Condor Code	Description	Weight (gms)	Part Number
Unloader valves			
EV3	With screw fitting for 6 mm plastic or copper discharge line	25	On Request
EV3i	With screw fitting for ¼" plastic or copper discharge line	25	3909020
EV3Wi + ST3	Right-angle valve with screw fitting for ¼" plastic or copper discharge line	18	3909031
EV3WS	Right-angle valve with quick-connect for 6 mm plastic discharge line	10	3909030
Unloader valves for difficult motor starting conditions			
AEV3	With screw fitting for 6 mm plastic or copper discharge line	25	On Request
AEV3WS	Right-angle valve with quick-connect for 6 mm plastic discharge line	18	3909032
Cable Glands			
PG13.5Z	With strain Relief	12	3919205
PG16V	Complete	12	3919210



The data provided above is for information purposes only and no warranty of accuracy or reliability is given. Ross Brown Sales Pty Limited reserves the right to change or modify this data without prior notice.

Rev 08/12

Pressure Switch MDR 3



Pressure Switch Accessories Continued

Condor Code	Description	Weight (gms)	Part Number
	Cover		
H3	Cover without rotary knob	100	3032920
H3-EA	Cover with rotary knob for manual On/Off switching	100	3032922
	Thermal, 3-pole overload relay		
SK3	Contact block without lock mechanism (supplied as standard with MDR3...)	90	3032930
SK3-S	Contact block with lock mechanism (supplied as standard with MDR3...+EA)	110	3032932
SK R3/1.0	0.63 - 1.00 Amps	145	On Request
SK R3/1.6	1.00 - 1.60 Amps	145	On Request
SK R3/2.5	1.60 - 2.50 Amps	145	On Request
SK R3/4.0	2.50 - 4.00 Amps	145	3032804
SK R3/6.3	4.00 - 6.30 Amps	145	3032805
SK R3/10	6.30 - 10.00 Amps	145	3032806
SK R3/16	10.00 - 16.00 Amps	145	3032807
SK R3/20	16.00 - 20.00 Amps	145	3032808
SK R3/24	20.00 - 24.00 Amps	145	3032809
SK R3/30/2	22.00 - 30.00 Amps, 240 Volts, 2 pole	145	3032810
SK R3H/16	10.00 - 16.00 Amps, (H type for higher switching capacity)	145	3032807C
SK R3H/20	16.00 - 20.00 Amps, (H type for higher switching capacity)	145	On Request
SK R3H/24	20.00 - 24.00 Amps, (H type for higher switching capacity)	145	On Request
	Under voltage and shunt releases		
RU3/230-50	Under voltage release 230 V, 50 Hz	100	3032924
RU3/400-50	Under voltage release 400 V, 50 Hz	100	3032925
RA3/480-60	Shunt release 480V, 60 Hz	100	On Request
RA3/240-60	Shunt release 240V, 60 Hz	100	On Request
RA3/230-50	Shunt release 230V, 50 Hz	100	3032820
RA3/110-50	Shunt release 110V, 50 Hz	100	On Request
RA3/24-50	Shunt release 24V, 50 Hz	100	On Request
	Hourmeter Kit		
H3-EA-B230	Hourmeter	230	3032950
H3-EA-B400	Hourmeter	230	3032951
	Miscellaneous		
DPA Board	Phase sequence control, phase failure control, under voltage release, other external contact (eg, temperature switch)	60	3032960
	Spares		
	¼" Nut & olive	25	3909099
	6mm nut & olive	25	3909098

Pressure Diagrams:

Standard Switches

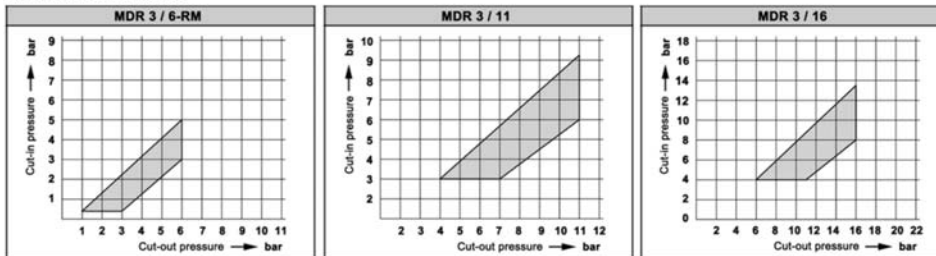

Standard Switches

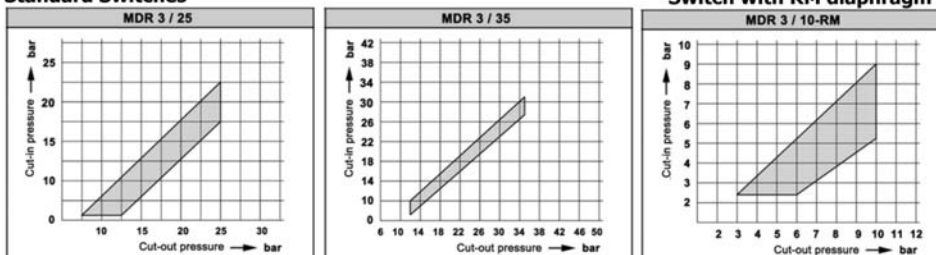

The data provided above is for information purposes only and no warranty of accuracy or reliability is given. Ross Brown Sales Pty Limited reserves the right to change or modify this data without prior notice.

Rev 08/12